



RT14 Cylinder Cap Fuse

1. General

- 1.1 Electric rating: AC380V, up to 63A;
- 1.2 Application: for protection of the power distribution apparatus against over-load and short circuit;
- 1.3 The combination of the fuse with impinger and the fuse type disconnecter can be used for phase-failure protection of motors.
- 1.4 stand: IEC 60269.

2. Type Designation

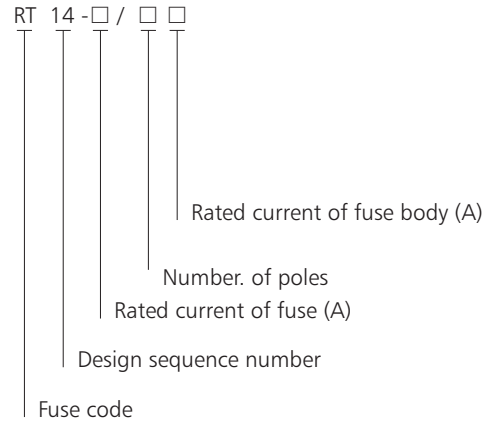

3. Basic Parameters and Dimensions

3.1 Accessories of the fuses

| Modle | Rated voltage (V) | Rated current (A) | Poles | Dimension | | | | | Mounting type |
|------------|-------------------|-------------------|--------|-----------|-------|----|-----|-----|----------------------------|
| | | | | A | B | C | L | H | |
| RT14-20 | 380 | 20 | Single | - | 20 | - | 69 | 46 | Screw, guide rail mounting |
| RT14-32 | 380 | 32 | Single | 166 | 26 | 55 | 104 | 56 | Screw mounting |
| RT14-63 | 380 | 63 | Single | 196 | 33.5 | 64 | 124 | 65 | Screw mounting |
| RT14-32/3P | 380 | 3×32 | Three | - | 78 | 55 | 104 | 100 | Screw mounting |
| RT14-63/3P | 380 | 3×63 | Three | - | 100.5 | 64 | 124 | 110 | Screw mounting |

3.2 Fuse body

| Modle | Dimension(G×K) | Matched fuse holder | Rated voltage (V) | Rated current (A) | Dissipated power | Rated breaking capacity (kA) | Impinger | Weight |
|---------|----------------|---------------------|-------------------|--------------------------------|------------------|------------------------------|----------|--------|
| RT14-20 | 10×38 | RT28-32, RT14-20 | 380 | 2, 4, 6, 8, 10, 16, 20 | ≤3 | 100 | No | 0.009 |
| RT14-32 | 14×51 | RT14-32, RT28-63 | 380 | 2, 4, 6, 8, 10, 16, 20, 25, 32 | ≤5 | 100 | No | 0.022 |
| RT14-63 | 22×58 | RT14-63, RT29-125 | 380 | 10, 16, 20, 25, 32, 40, 50, 63 | ≤9.5 | 100 | No | 0.06 |

Fuses

3.3 Over view of fue body matched with fuse holder RT14, RT28, RT29

| Model of fuse holder | Matched fuse | | | | |
|----------------------|--------------|-------------------|---------------------------|--------|----------------------------------|
| | Dimension | Rated voltage (V) | Model of fuse | Phase | Current (A) |
| RT14-20 | 10×38 | 380 | RT14-20 | Single | 2, 4, 6, 8, 10, 16, 20 |
| RT14-32 | 14×51 | 380 | RT14-32, RT28-63 | Single | 2, 4, 6, 8, 10, 16, 20, 25, 32 |
| RT14-63 | 22×58 | 380 | RT14-63, RT29-125 | Single | 10, 16, 20, 25, 32, 40, 50, 63 |
| RT29-16 | 8.5×31.5 | 380 | RT29-16 | Single | 2, 4, 6, 8, 10, 16 |
| RT28-32 | 10×38 | 380 | RT14-20, RT28-32 | Single | 2, 4, 6, 8, 10, 16, 20, 25, 32 |
| RT29-32 | | | | | |
| RT28-63 | 14×51 | 380 | RT14-32, RT28-63, RT29-63 | Single | 10, 16, 20, 25, 32, 40, 50, 63 |
| RT29-63 | | | | | |
| RT29-125 | 22×58 | 380 | RT14-63, RT29-125 | Single | 25, 32, 40, 50, 63, 80, 100, 125 |

RT14-20

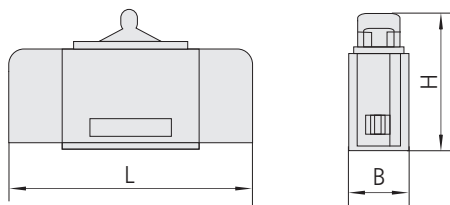

RT14-20 fuse base

RT14-32, RT14-63

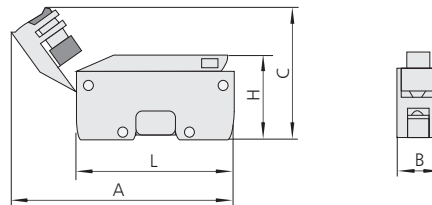

RT14-32, RT14-63 fuse base

RT14-32/3P, RT14-63/3P

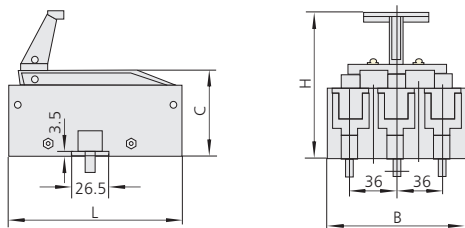

RT14-32/3P, RT14-63/3P fuse base

Fuse size G×K



Rt14 fuse base

